



# BOSK



NEW ZEALAND.COM  
Licence No. 100610

**10**  
**YEAR**

WARRANTY



## FEATURES

- Bosk panels are perforated and slotted sheets in a variety of finishes which achieve a high level of absorptive acoustic performance. They are ideal for use in commercial interiors, lobbies, gymnasiums, restaurants, schools and residential applications. Bosk is highly durable and available in a many iterations to achieve the desired design aesthetic.
- Constructed in sheet form for easy use as a wall and ceiling lining, and also available in tile form for placement in a suspended ceiling system.
- The panels are sourced from the Prime Panel and Bestwood ranges from NZ Panels Group and all their sheet options in 12mm or thicker are available for perforation.
- Bosk Panels meets Group 1-S fire test requirement; or Group 3 test requirements.
- The panels come with standard black acoustic backing material and additional polyester acoustic insulation is available. Variable NRC ranges from 0.35 up to 0.75 dependant on perforation.
- Bosk panels are available in a range of perforation patterns or bespoke options. Standard sheet sizes are 1200 x 2400mm for full sheets or 600 x 600mm and 600 x 1200mm for ceiling panels.

V1.0 03/24





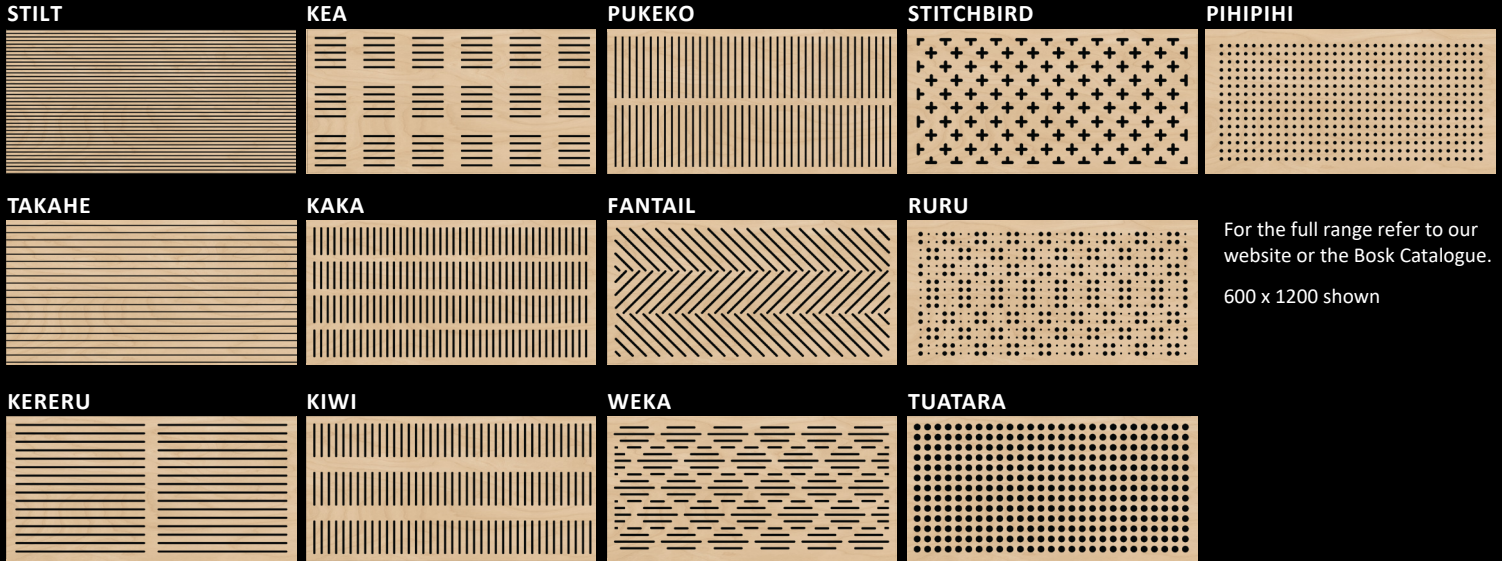

For the full range refer to our website or the Bosk Catalogue.  
600 x 1200 shown

## COLOURS

Bestwood and Prime Melamine are a favourite of New Zealand interior designers, architects and joiners. Their range of easy care, pre-finished, panels are available in a large range of finishes with their iconic timber aesthetic. Inspired by the warmth and nature beauty of timber.

### Bestwood colour range



### Primepanels colour range



For the full range refer to our website or the Bosk Catalogue.

## FIRE GROUP NUMBER CHART

PROPERTIES	TEST METHOD	UNITS	RESULT
Prime Melamine on MDF FR Black	C/AS2	Group Number	Group 1-S
Prime Veneer on MDF FR Black coated with a 2 pack low yellowing polyurethane	C/AS2	GroupNumber	Group 1-S
Prime Veneer on MDF Standard	C/VM2	GroupNumber	Group 3
Prime MDF FR Black	C/AS2	GroupNumber	Group 1-S

### VEE JOINT

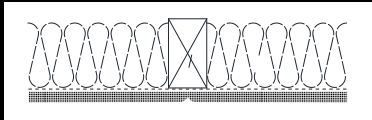

### EXPRESSED JOINT

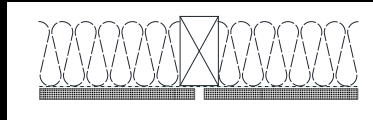

### SUSPENDED CEILING

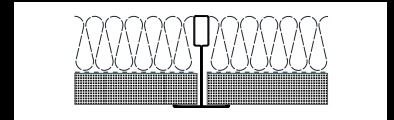

Boskpanels are a woodbasedproduct so consideration needs to be taken regarding expansion and contraction-especially overlarge areas.

## BLACK FRBOARD TECHNICAL DATA

### TECHNICAL DATA-AVERAGE VALUES

REV: 01/03/2022

PROPERTIES	TEST METHOD	UNITS	10 - 12mm	>12 - 19mm
			DENSITY (*)	EN 323
INTERNAL BOND	EN 319	N/mm <sup>2</sup>	0.60	0.55
BENDING STRENGTH	EN 310	N/mm <sup>2</sup>	22	20
MODULES OF ELASTICITY	EN 310	N/mm <sup>2</sup>	2500	2200
THICKNESS SWELLING 24H	EN 317	%	15	12
DIMENSIONAL MOVEMENT LENGTH/WIDTH	EN 318	%	0.4	0.4
DIMENSIONAL MOVEMENT THICKNESS	EN 318	%	6	6
MOISTURE CONTENT	EN 322	%	7 +/- 3	7 +/- 3
GRIT CONTENT	ISO 3340	% Weight	≤ 0.05	≤ 0.05
FORMALDEHYDE EMISSION	EN 717-1	ppm	≤ 0.05	≤ 0.05
SOUND ABSORPTION COEFFICIENT (A) (250 A 500 HZ)	EN 13984:2004+A1:2015	α	0.10	0.10
SOUND ABSORPTION COEFFICIENT (A) (1000 A 2000 HZ)	EN 13984:2004+A1:2015	α	0.20	0.20
THERMAL CONDUCTIVITY	EN 13984:2004+A1:2015	W/ (m-K)	0.14	0.14
AIRBORNE SOUND INSULATION (SURFACE MASS) (R)	EN 13986:2004+A1:2015	db	25	27
WATER VAPOUR PERMEABILITY DRY CUP	EN 13986:2004+A1:2015	μ	30	29
WATER VAPOUR PERMEABILITY WET CUP	EN 13986:2004+A1:2015	μ	2'	19
BIOLOGICAL DURABILITY USE <small>Class 1 rating for interior use only</small>	EN 335	Class of use	1	1
CONTENT OF PENTACHLOROPHENOL (PCP)	EN 13986:2004+A1:2015	ppm	< 5	< 5

V1.0 03/24